

L-864 ZL2000 Series Red LED Medium Intensity Beacon

Compliance:

- ICAO Annex 14, Volume I, 6th Edition, July, 2013
- ICAO Aerodromes Design Manual, Chapter 18
- FAA AC150/5345-43G
- FAA Engineering Brief 67 Specifications

Applications:

- ICAO medium intensity type B
- ICAO medium intensity type C
- FAA L-864 type

Advantages:

- Improved ingress grade IP67.
- Portable and lightweight, easy transportation.
- Fixture can be used with 100V~250V AC, 50Hz or 60Hz.
- LED low power consumption only 5 Watts average.
- EMC compliant design,
- Resistant to shock vibration, corrosion resistant.

Technical Features:

- Operation voltage:85V~265V AC, 12V~60V DC.
- Lamp:100,000 hours high quality LED.
- FPM:20 to 60 flashes/per minute.
- Color:Red.
- Flash/Fixed:Both available.
- Power consumption:Flash 5W/Steady 40W.
- Output:360° horizontal; Centering at 0.5°.
- Photo sensor:100Lux.
- Housing: casting aluminum&PC lens cover.
- Finish: UV stablized spraying plastic.
- Overall size: $\phi 22.7\text{cm} \times 19\text{cm}$.
- Weight: 4.5KG.
- Operating: -40°C to 60 °C.
- Wind speed: 80m/s.

Photometric:

- >2000cd at 0°
- >950cd at -1°

Ordering Options:

- Phtocell functions.
- GPS synchronized flashing.
- Failure alarm output.
- Colors options red, white, blue, yellow, green.
- Flash or steady burning mode available.
- Solar powerd supply please check at next page.



It is used increase conspicuity of structures or obstructions during nighttime.

Widely used in any obstruction like high-rise buildings, chimney, telecom towers, transimission power towers, airports,wind turbines and crane machines.

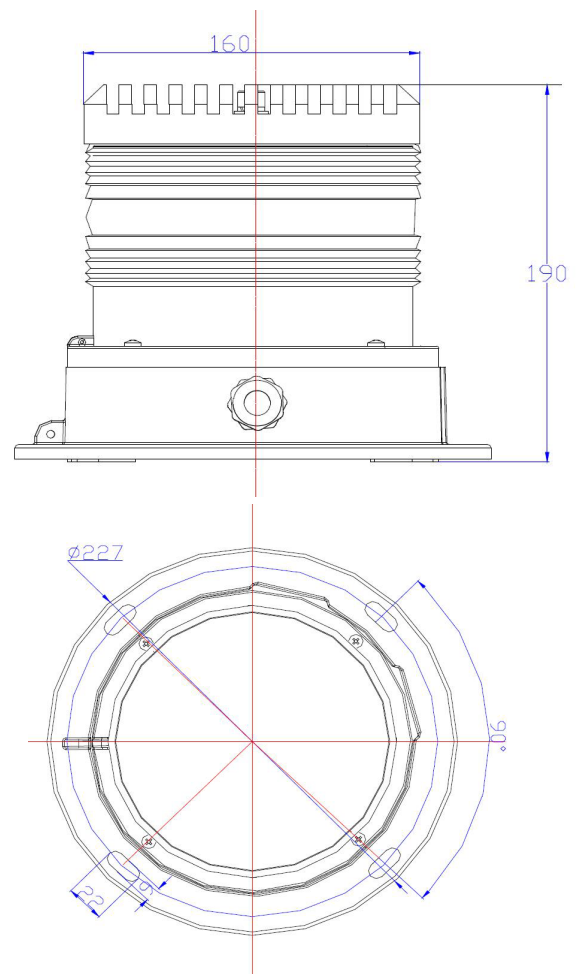

L-864 ZL2000 Series Red LED Medium Intensity Beacon

SOLAR POWERED

Solar Powered Type:

- ZL2000 type red flashing beacon equipped with free-maintenance solar powered system.

Solar Panel &Photo cell:

- Polycrystalline silicon type (standard) or Monocrystalline type.
- Solar panel, Size: 67*50*17(cm), weight 2.5KG.
- Photo cell is built-in the solar panel, the single/double obstacle light system will automatically turn-on/off based on environment lux from 5~500Lux.

Housing:

- Angle adjustable for solar panel.
- The control box was sealing and constructed by metal box, whole unit IP65, 4 pcs of anti-shedding screws locked.
- Battery was protected and placed inside the metal box.

Battery Management System:

- Lead acid battery 12V 12AH type.
- Battery can operate at -15°C to 45 °C
- Battery can allow the single/double obstacle light system work more than 15 days~20days.

Package:

- 15KG gross weight.
- 42cm*39cm*45cm per package size.

Photometric:

- >2000cd at 0°
- >950cd at -1°

Ordering Options:

- GPS synchronized flashing.
- Flash frequency customized as per requirement.
- Manual switch changeover from solar power to AC building power in case solar power failures.
- Flash or steady burning mode available.

Applications:

- ICAO medium intensity type B
- ICAO medium intensity type C
- FAA L-864 type

